

Terminal Boxes BXJ Series Explosion-proof Terminal Boxes



Ex d IIB

- ◆ Explosion protection to
 - CENELEC
 - IEC
 - NEC
- ◆ Can be used in
 - Zone 1 and Zone 2
 - Zone 21 and Zone 22
 - Class I, Zone 1 and Zone 2
 - Class I, Division 1, Groups A, B, C, D
 - Class I, Division 2, Groups A, B, C, D
- ◆ Three explosion-proof types (Ex e, Ex d IIB and Ex d IIC).
- ◆ Enclosure: Copper-free aluminium (carbon steel or stainless steel is optional), powder coated surface.
- ◆ Size and direction of cable entries can be customized on request.

■ Catalogue number logic

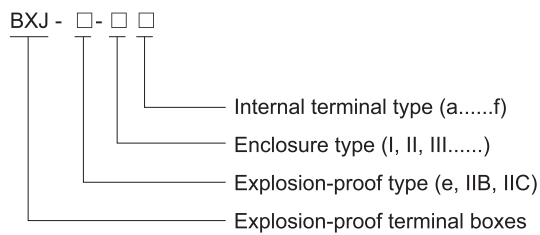

Ex d IIC



Ex e IIC

Zones 1&2; 21&22

Terminal Boxes

BXJ-IIC Series Explosion-proof Terminal Boxes

Technical data

Explosion-proof terminal boxes (Ex d IIC) BXJ- IIC-□□

Explosion protection																			
Gas explosion protection	⊕ Ex II 2 G Ex d IIC T6 Gb																		
Dust explosion protection	⊕ Ex II 2 D Ex tb IIIC T80°C Db IP65																		
Certificates	Nemko 09 ATEX 1012; IECEx CQM 11.0027; KZ.7500525.22.01.00364 (CU-TR)																		
Conformity to standards	EN 60079-0, EN 60079-1, EN 60079-31 IEC 60079-0, IEC 60079-1, IEC 60079-31																		
Enclosure material	Copper-free aluminium (carbon steel or stainless steel is optional), powder coated surface																		
Enclosure colour	Window grey (RAL7040)																		
Terminal	International brand of terminal																		
Exposed fastener	Stainless steel																		
Rated voltage	Max. 690V AC																		
Rated current	<table border="1"> <tr> <td>Cross section</td> <td>2.5mm²</td> <td>4mm²</td> <td>6mm²</td> <td>10mm²</td> <td>16mm²</td> <td>35mm²</td> <td>70mm²</td> <td>95mm²</td> </tr> <tr> <td>Rated current</td> <td>24A</td> <td>32A</td> <td>41A</td> <td>57A</td> <td>76A</td> <td>125A</td> <td>192A</td> <td>250A</td> </tr> </table>	Cross section	2.5mm ²	4mm ²	6mm ²	10mm ²	16mm ²	35mm ²	70mm ²	95mm ²	Rated current	24A	32A	41A	57A	76A	125A	192A	250A
Cross section	2.5mm ²	4mm ²	6mm ²	10mm ²	16mm ²	35mm ²	70mm ²	95mm ²											
Rated current	24A	32A	41A	57A	76A	125A	192A	250A											
Degree of protection	IP65																		
Ambient temperature	-20°C~+55°C																		
Note	Rated current > 250A on request																		

Cable entry table

Table of max. number of possible enclosure entries with cable glands DQM-II

	I		II		III		IV		V		VI	
	A/B	C/D	A/B	C/D	A/B	C/D	A/B	C/D	A/B	C/D	A/B	C/D
M20×1.5	3	3	4	4	10	10	11	11	15	15	17	17
M25×1.5	3	3	4	4	9	9	10	10	13	13	15	15
M32×1.5	2	2	3	3	7	7	8	8	11	11	12	12
M40×1.5	2	2	3	3	3	3	4	4	5	5	5	5
M50×1.5	/	/	/	/	3	3	3	3	4	4	5	5
M63×1.5	/	/	/	/	2	2	2	2	3	3	4	4

Note: 1. No cable entries for standard design. Cable entries shall be drilled by user.

2. For cable entries:

1) Please specify the direction and size of each cable entry.

2) Cable gland is optional, DQM-II (Ex d) or DQM-III (Ex d) is recommended. Please see P7/20~27.

Terminal Boxes

BXJ-IIC Series Explosion-proof Terminal Boxes

Selection table of BXJ-IIC series explosion-proof terminal boxes

Max. cross section of cable connected to terminals is 95mm²

See table for max. number of fitted terminals

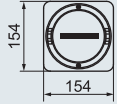
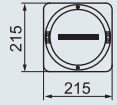
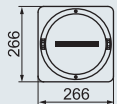
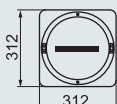
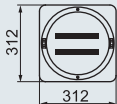
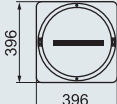
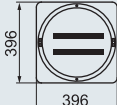
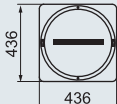
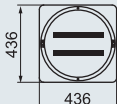
Cross section of cable (mm ²)		2.5 (a)	4 (b)	6 (c)	10 (d)	16 (e)	35 (f)	70 (g)	95 (h)	Weight (kg)
Enclosure code/Ordering code	Outline									
I		10	8	6	—	—	—	—	—	3.50
II		20	18	15	12	10	—	—	—	6.50
III		25	24	20	15	12	6	—	—	12.00
IV		32	30	25	18	14	10	—	—	15.00
IV		44	40	32	22	—	—	—	—	15.50
V		48	44	38	30	20	12	6	6	21.00
V		72	60	50	40	—	—	—	—	21.50
VI		60	54	44	34	26	15	8	8	24.00
VI		90	80	60	50	40	—	—	—	24.50



Terminal Boxes BXJ Series Explosion-proof Terminal Boxes

Dimension drawings (all dimensions in mm) - subject to alteration

BXJ- IIC-□□

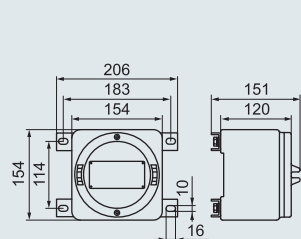

Type I

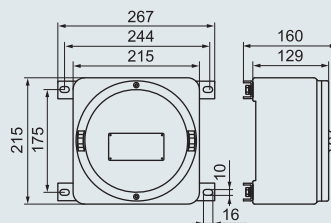

Type II

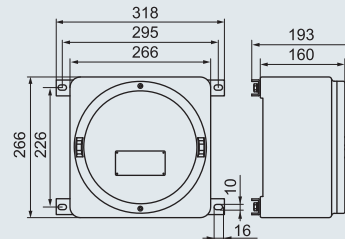

Type III

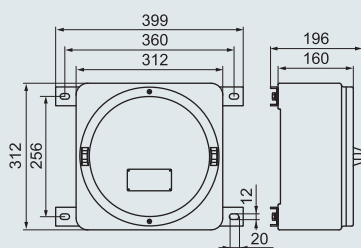

Type IV

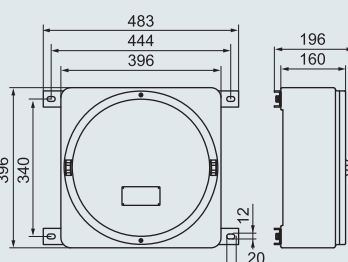

Type V

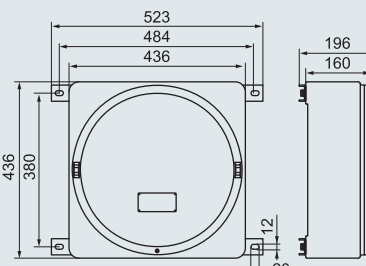

Type VI

Dimension drawings (all dimensions in mm) - subject to alteration

BXJ- e-□□

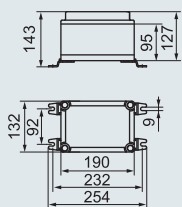

Type I

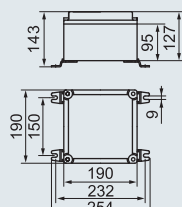

Type II

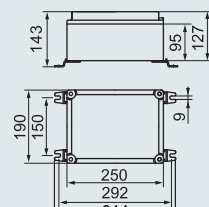

Type III

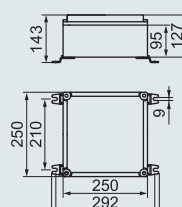

Type IV

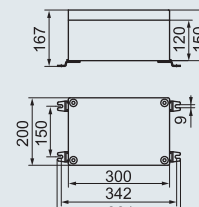

Type V

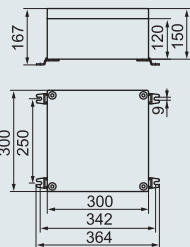

Type VI

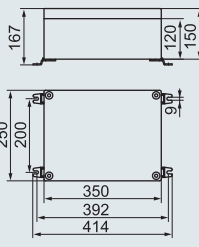

Type VII

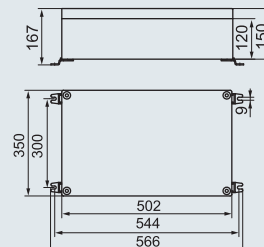

Type VIII

